

HELI

CDD12J/CDD12JD Electric pallet stacker

Characteristics:

- 1.High power lift pump has high working efficiency.
- 2.Side driving design achieves a smaller steering radius and wide view.
- 3.The driving system with permanent magnetic motor has small volume,light weight and low consumption.
- 4.German water-proof inching switch meets the requirements of harsh working condition such as cold,humidity and dust circumstances.
- 5.Four colors LED electricity meter makes it simple and easy to read.
- 6.External charger has better cooling performance.
- 7.It's more comfortable and easier for operator using a super long handle that integrates with lifting button,key switch,electricity meter,which is suitable for ergonomics;more accurate speed control with turtle speed switch;more durable with high quality air-pressure aprings which allows slowly and automatically reset.
- 8.Iron steel protection guard with high density,which is more durable,firm and has high protection effect.
- 9.Maintenance-free battery.
10. Optional: Lithium battery.



CDD12J/CDD12JD

Manufacturer's Data and Design Characteristics									
Characteristics									
1.01	Manufacturer	HELI							
1.02	Model	CDD12J							CDD12JD
1.03	Operation	Pedestrian propelled							
1.04	Rated traction weight	Q (kg) 1200							
1.05	Mast type	Single mast	2- Stage STD						Mono mast
1.06	Lift	h3 (mm)	1600	2000	2500	3000	3300	3500	1600
1.07	Capacity at highest height	kg	1200	1050	900	750	660	600	1200
1.08	Load centre	c (mm)	600						
1.09	Axle centre to fork face	x (mm)	710						
1.10	Wheel base	y (mm)	1154						1031
1.11	Controller	CURTIS							
Wheels/Tyres									
2.01	Wheels type	Φ×w(mm)	Polyurethane						
2.02	Driving wheel size	Φ×w(mm)	Φ210×70						
2.03	Bearing wheel size	Φ×w(mm)	Φ80×70						
2.04	Additional wheels (dimensions)	Φ150×58							
2.05	Wheels, number front/rear (x = driven)	1x+1/4							
Dimensions									
3.01	Height of mast, lowered	h1 (mm)	2014	1494	1744	1994	2144	2244	1990
3.02	Height of mast, extended	h4 (mm)	2014	2424	2924	3424	3724	3924	2060
3.03	Fork Height, Lowered	h13 (mm)	86						
3.04	Overall length	l1 (mm)	1755						1632
3.05	Length to fork face	l2 (mm)	605						482
3.06	Overall width	b1/ b2 (mm)	795						
3.07	Fork dimensions	s/e/l (mm)	60/160/1150						
3.08	Width of forks	b5 (mm)	570/650/695						
3.09	Min.Ground clearance	m2 (mm)	24						
3.10	Aisle width with pallet 1000 x 1200 across forks	Ast (mm)	2068						2048
3.11	Aisle width with pallet 800 x 1200 along forks	Ast (mm)	2034						2014
3.12	Min.Turning radius	Wa (mm)	1366						1316
Performance									
4.01	Travel spees,with/without load	(km/h)	4.0/4.2						
4.02	Lifting speed, with/without load	(mm/s)	92/136						
4.03	Lowering speed, with/without load	(mm/s)	112/98						
4.04	Max. gradeability laden/unladen	(%)	6/8						
4.05	Service brake	Electromagnetic brake							
Drive									
5.01	Drive motor,output S2 60 min.	(kW)	0.75						
5.02	Lift motor rating at S3 15%	(kW)	2.2						
Lead-acid battery									
6.01	Battery according to DIN 43531/35/36 A,B,C,no	no							
6.02	Battery voltage/rated capacity	(V/Ah)	2×12/100						
6.03	Battery weight (± 5%)	(kg)	2×27						
6.04	Service weight(include battery)	kg	425	441	453	465	472	477	395
Lithium battery (Optional)									
7.01	Battery according to DIN 43531/35/36 A,B,C,no	no							
7.02	Battery voltage/rated capacity	(V/Ah)	24/60 (LFP)						
7.03	Battery weight (± 5%)	(kg)	15						
7.04	Service weight(include battery)	kg	386	402	414	426	433	438	356
Others									
8.01	Noise level at operator's ears	(dB(A))	69						
8.02	Steering type	Mechanical steering							

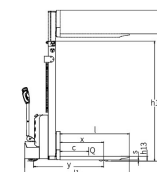
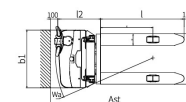

ANHUI HELI CO., LTD.
Add / No.668, FangXing Road, Hefei, China
Fax / +86-551-63639966

Tel / +86-551-63639068(America); 63639258(Europe);
63639358(Asia); 63662105(Africa & Middle East);
63639530(Key Accounts Division); 63662105(Wheel loader)