



AC POWER | ES10-10WA/ES12-12WA
Bias Electric Stacker 1.0-1.2t

EP EQUIPMENT CO., LTD
www.ep.com

Performance & Reliability

1. The innovative AC system offers quick response, accurate control, impact structure, excellent performance, longer battery service life.
2. The innovative AC motor provides stronger power to keep high speed with full load. 8% gradeability, provides increased power to climb docks and floor joints without lurching or stalling.
3. World-class hydraulic power pack, with low noise, few vibration and excellent leak tightness, automatically adjusts the rate of decline whether loaded or unloaded, and ensures smooth lifting.



Operability

1. The ergonomically designed handle ensures smooth and easy controls of all operation. All the operation of lifting and travelling, will be easily achieved by touching the button switches in the handle.
2. Operating handle is on the side, allowing operators to work with greater vision.
3. Sideway battery design for easy battery replacement.



Safety

1. Explosion-proof valve installed under lifting cylinder, prevent the mast go down quickly if the oil pipe broken.
2. Anti-roll back available as standard to prevent uncontrolled traveled travel speed or roll-back on ramps when loading and unloading.
3. Easy-Touch emergency plug mounted at up-right side on truck frame help operator take immediate action for any emergent happens.
4. The truck switches to low speed mode automatically when lifting higher than 0.5m, more secure.



Bias Electric Stacker 1.0-1.2t Specification

Characteristics	EP	EP
1.1 Manufacturer	ES10-10WA	EP
1.2 Model designation	Battery	ES12-12WA
1.3 Drive unit	Walkie	Battery
1.4 Operator type	1000	Walkie
1.5 Load capacity	Q (kg)	1200
1.6 Load center	c (mm)	600
1.8 Load distance	x (mm)	700
1.9 Wheelbase	y (mm)	1218
Weights		
2.1 Service weight (incl. battery)	kg	1050
2.2 Axle loading, laden operator/load site	kg	750/1500
2.3 Axle loading, unladen operator/load site	kg	715/335
Wheels, Chassis		
3.1 Tyre type	PJ/PU	PJ/PU
3.2 Tyre size, operator site (diameter x width)	230x 75	230x 75
3.3 Tyre size, load site (diameter x width)	85x 70	85x 70
3.4 Balance wheels (dimensions)	85x 50	85x 50
3.5 Wheels, number operator/load site (x=drive wheels)	1x+ 1/2	1x+ 1/2
3.6 Tread, operator site	b ₁₀ (mm)	538
3.7 Tread, load site	b ₁ (mm)	380
Dimensions		
4.2 Height, mast, lowered	h ₁ (mm)	1970
4.3 Free lift	h ₂ (mm)	100
4.4 Lift height	h ₃ (mm)	3000
4.5 Height, mast, extended	h ₄ (mm)	3529
4.9 Height of tiller arm in operating position, min/max	h ₅ (mm)	825/ 1225
4.15 Fork height, lowered	h ₁₅ (mm)	85
4.19 Overall length	L ₁ (mm)	1828
4.20 Length to face of forks	L ₂ (mm)	676
4.21 Overall width	b ₁ /b ₂ (mm)	800
4.22 Fork dimensions	s/ e/ l (mm)	60/ 170/ 1150
4.25 Outside fork width, minimum/ maximum	b ₃ (mm)	550
4.32 Ground clearance	m ₃ (mm)	30
4.33 Aisle width, 1000x1200 pallet, crossways	Ast (mm)	2370
4.34 Aisle width, 800x1200 pallet, lengthways	Ast (mm)	2303
4.35 Outer turning radius	Wa (mm)	1463
Performance		
5.1 Travel speed, laden/unladen	km/ h	5/ 5.5
5.2 Lifting speed, laden/unladen	m/ s	0.127/ 0.15
5.3 Lowering speed, laden/unladen	m/ s	0.23/ 0.22
5.8 Maximum gradeability, laden/unladen	%	8/ 16
5.10 Service brake		Electromagnetic
Drive		
6.1 Drive motor rating, S ₁ , 60 min.	kW	1.1
6.2 Lift motor rating, at S ₁ , 15%	kW	2.2
6.4 Battery voltage/ rated capacity (Ah)	V/Ah	24/ 160
6.5 Battery weight, (with box)	kg	205
Battery compartment dimensions l/w/h	mm	650/ 540/ 200
Battery type		Industry battery
Others		
8.1 Type of drive control	AC	AC
8.4 Sound level at operator's ear	dB (A)	ZAP1
Manufacturer		74

1. Special lifting height, available
2. The specification in the table are for standard models only. For further information please contact us
3. Speed fluctuation are subject to change without notice

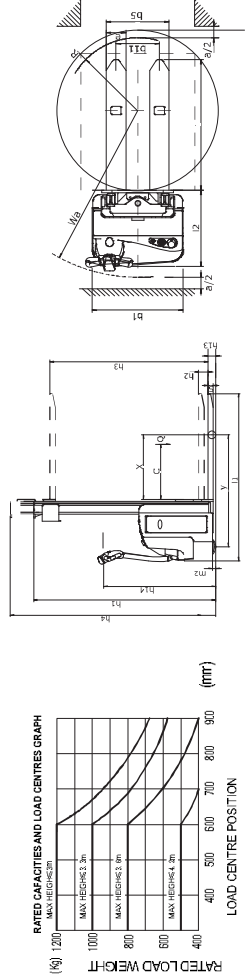

EP ES10-10WA/ES12-12WA
Electric Initial Lift 1.0-1.2t